

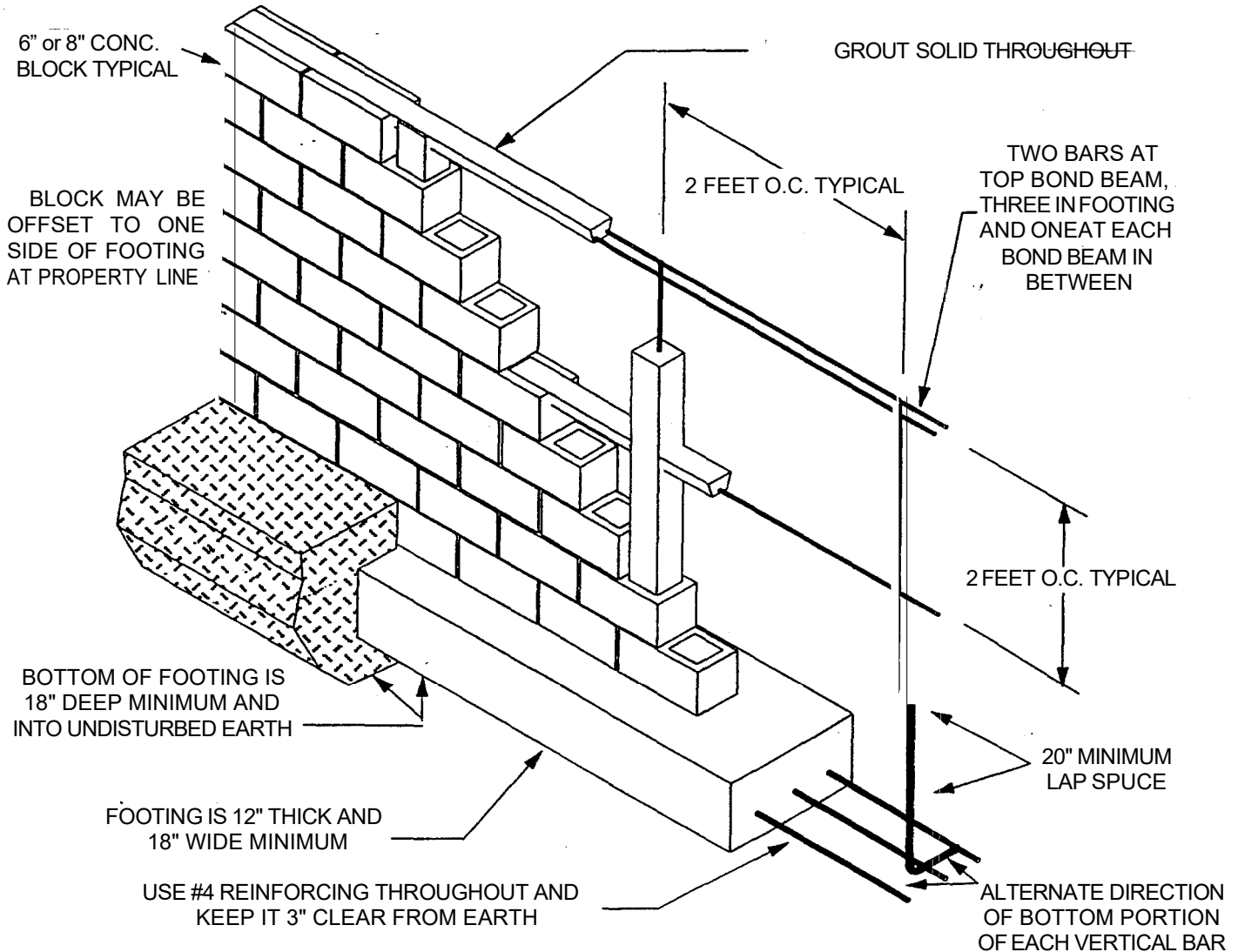

# BLOCK WALL

In Seismic Areas With Expansive Soil



1. **GENERAL:** THIS INFORMATION SUMMARIZES CERTAIN PARTS OF THE "CALIFORNIA RESIDENTIAL CODE" (CRC) & THE CALIFORNIA BUILDING CODE (CBC). THIS HANDOUT IS NOT A REPLACEMENT FOR THE CRC OR CBC. IT IS SIMPLY AN ATTEMPT TO MAKE CERTAIN PARTS OF IT MORE ACCESSIBLE. WHERE UNUSUAL CONDITIONS ARE ENCOUNTERED OR WHERE OTHER CHOICES ARE DESIRED, A PROFESSIONAL ENGINEER SHALL BE CONSULTED.
2. **CONCRETE BLOCK (ASTM C-90):** STRENGTH OF MASONRY TO COMPLY WITH 2025 CBC 2105 AND ACI 530-14. GRADE "N" CONFORMING TO ASTM C-90 NORMAL WEIGHT UNITS WITH MAXIMUM LINEAR SHRINKAGE OF 0.06%,  $f_m = 2,000$  PSI MIN. CBC 2105.2
3. **CONCRETE:** CONCRETE MIX SHALL BE TYPE V 4,500 PSI. CONCRETE JUSTIFIED BY TESTING TO BE IN NON-CORROSIVE ENVIRONMENT AND NOT IN (NON-SALT WATER, MARINE OR IN CONTACT WITH SULFATES/ SOILS) MAY BE TYPE II 2,500 PSI STRENGTH. CRC R404.1
4. **MORTAR (ASTM C-270):** MORTAR SHALL BE OF TYPE "S" HAVING MIN. STRENGTH OF 2,000 PSI. DO NOT USE PLASTIC OR CEMENT OR MASONRY CEMENT. THEY ARE PROHIBITED IN THIS SEISMIC ZONE.
5. **GROUT:** GROUT SHALL HAVE A COMPRESSIVE STRENGTH OF 2,000 PSI AT 28 DAYS.
6. **STEEL REINFORCING BARS (ASTM 615):** REINFORCING BARS SHALL BE MIN GRADE 40,  $F_y = 40$ KSI FOR #4 AND SMALLER AND GRADE 60,  $F_y = 60$  KSI FOR #5 AND LARGER AS PER ASTM 615 BILLET STEEL. CRC R402.3
7. **HEIGHT:** FENCES MAY NOT EXCEED 6' IN HEIGHT. PLANNING DIVISION APPROVAL WILL BE REQUIRED FOR ANY WALL THAT IS OVER 3'-6" HIGH IN THE 20' FRONT YARD SETBACK OR IN THE 10' STREET SIDE YARD SETBACK.
8. **VERIFICATION** OF PROPERTY LINE IS NEEDED. A SURVEY MAY BE REQUIRED.